

Attaches to: All Mount'n Mover device plates and trays

- Universal rotator to device plate or tray
- (These screws are not provided with Universal Rotator; Provided with device plate)*
- 8-32 x 1/4" Flathead Screws (x4)

Loosen knob, rotate plate 45 degrees to expose holes for attachment to device plate or tray

45°

Align with holes to attach Quick Release Plate (QRP) (supplied)

8-32 x 3/16" (x4)

2.50in
63.5mm

2.00in
50.8mm

2.00in
50.8mm

Mount'n Mover™
by BlueSky Designs

mountnmover.com

Product: DP-UR, Universal Rotator
Weight: 7.6 oz. (0.22 kg)

1-888-724-7002 (toll free) or 1-612-724-7002

pg 1 of 2

Universal Rotator (UR)

Attach device plate to device
(shown with Dynavox Eyemax)

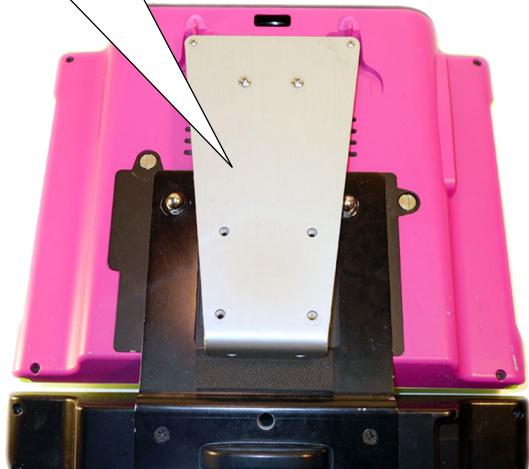

To adjust rotation:

1. Loosen knob
2. Rotate device
3. Tighten knob

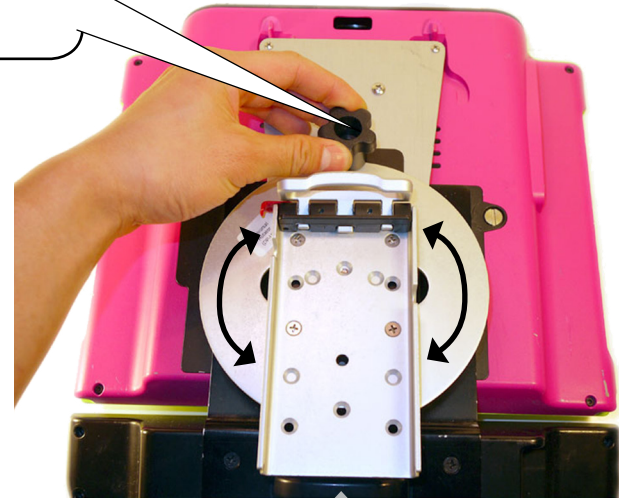

1. Loosen knob
2. Rotate plate to expose device attachment holes

Attach UR

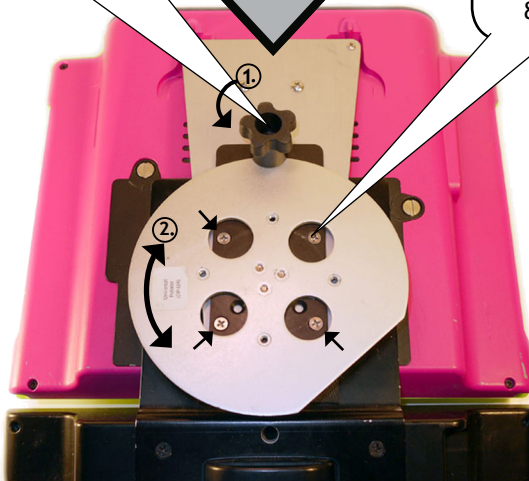

3. Screw UR to device plate
(screws included with device plate)
8-32 x 1/4" (x4)



Attach QRP

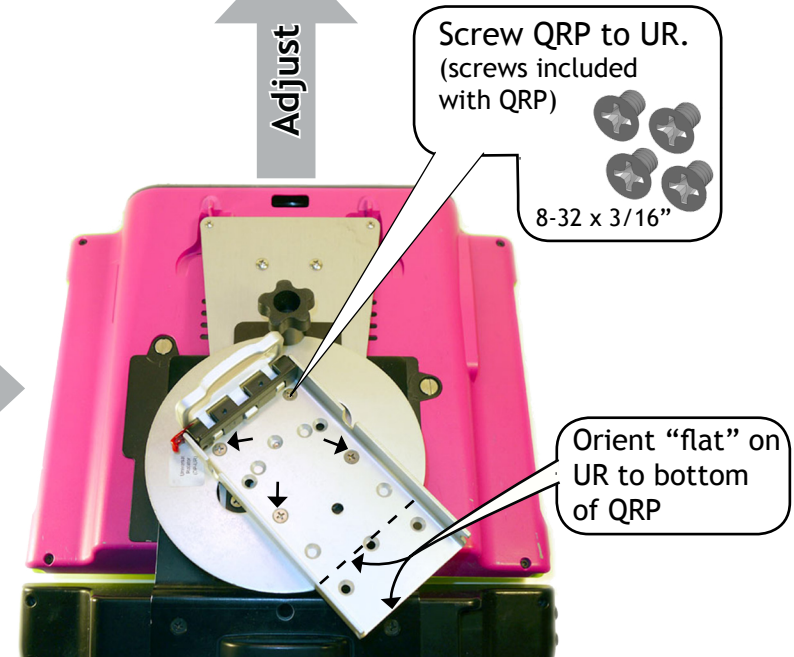

Screw QRP to UR.
(screws included with QRP)

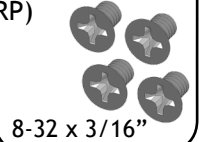

8-32 x 3/16"

Adjust