

Mount'n Mover™

by BlueSky Designs

quick guide

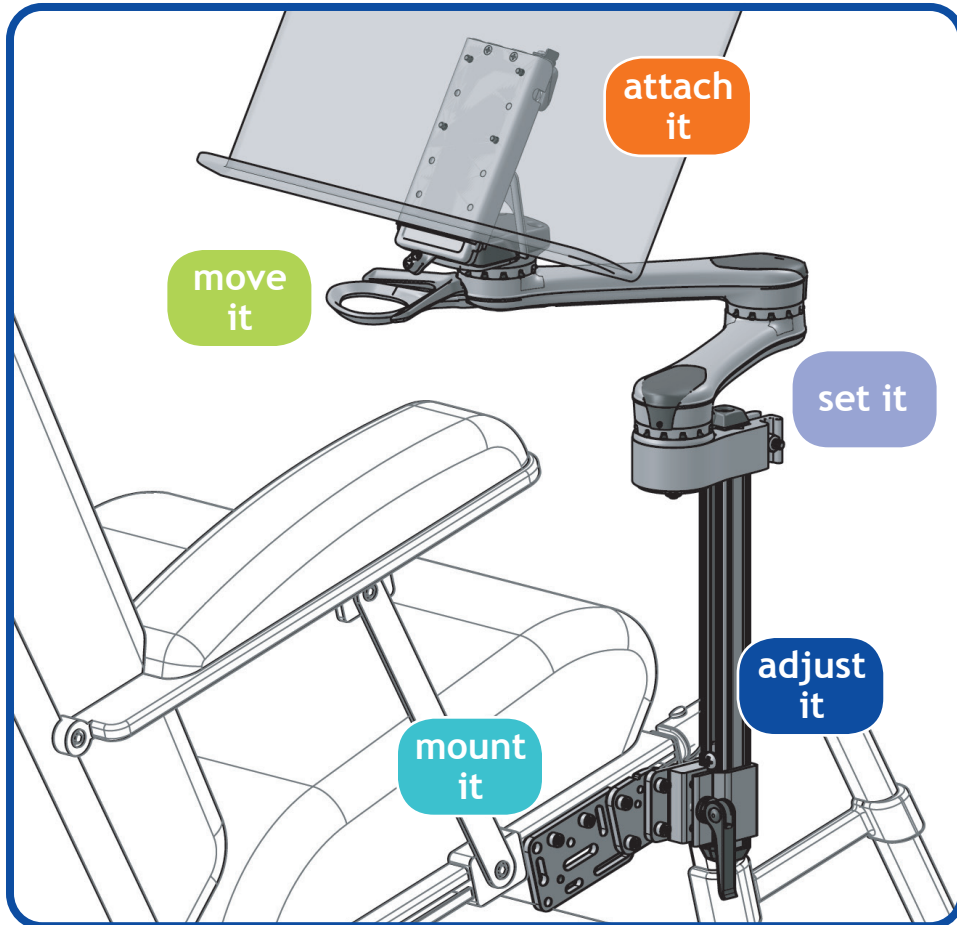

This guide describes the basics of setting up your **Mount'n Mover** so that it stops at, moves from, and returns to any desired position. For further assistance, please call us at **888-724-7002**, or check out our website for more detailed instructions.

mountnmover.com

move it

- move shoulder & elbow joints
- rotate wrist joint
- change tilt-plate angle

Depress **HOOP** to unlock elbow & shoulder joints

Move It from lock position

To find lock position
release downward
pressure on hoop and
move until arm stops

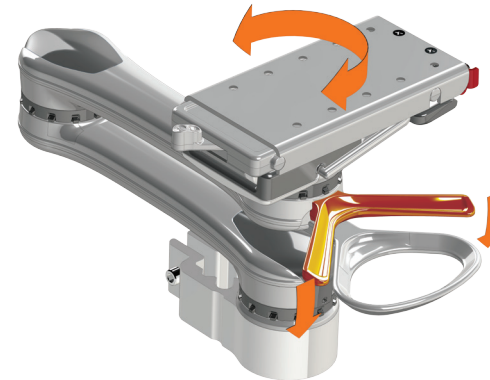

Depress **PADDLE** to release the wrist lock

Move it

Wrist will remain unlocked until it reaches lock position

Slide **LEVER** to the *right* to unlock the tilt-plate

Position the tilt-plate to the desired orientation

Slide the **LEVER** to the *left to lock* the tilt-plate

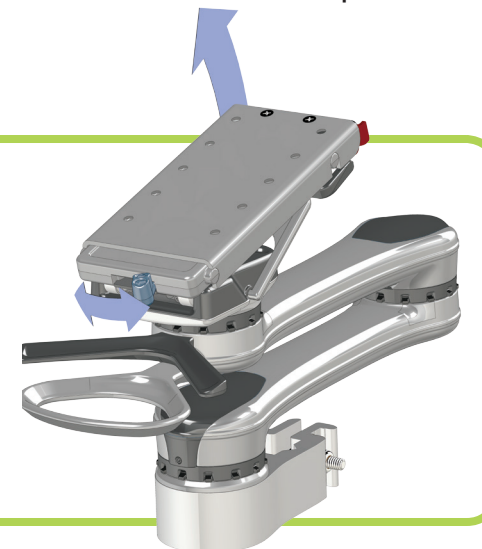

attach it

- detach Quick Release Plate (QRP)
- reattach QRP
- attach device to device plate



- a: Release “red lock” by rotating clockwise
b: Unlock by pulling out & up on handle (highlighted orange)
c: Lift off by pulling forward and up

Reverse these steps to re-attach to device plate

step 1

attach device to appropriate device plate

step 2

attach to quick release plate

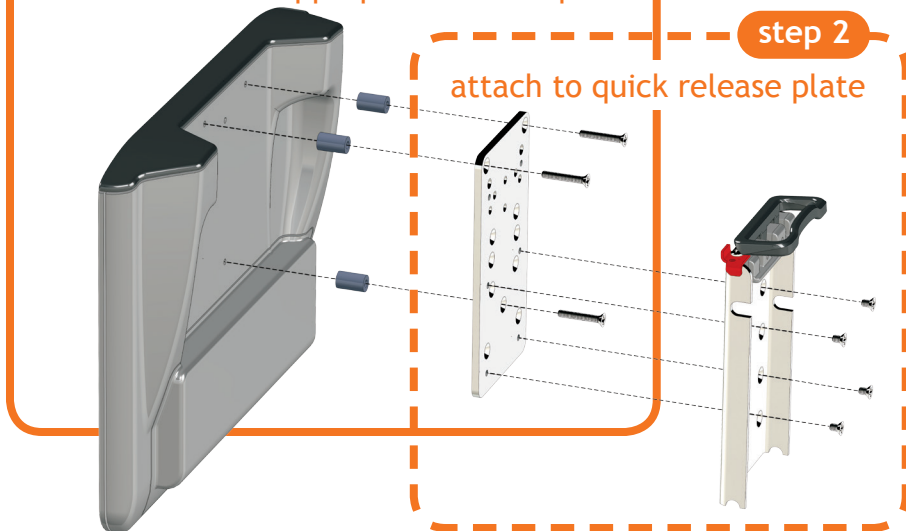

set it

To set custom lock positions:
Align set-screw with desired lock position and slide lock tab down

initial setup

Flip up all lock tabs so joints move freely with no lock positions

⚠ You cannot unset a lock tab with the set-screw directly above it

Orient to best fit user needs;
move set-screw to nearest lock tab;
slide lock tabs down to set locks



fine tune

⚠ Must start with Lock Position at Shoulder

- a: Remove bolt cover
- b: Loosen bolt (120° CCW)
- c: Rotate shoulder
- d: Tighten bolt (120° CW)
- e: Replace bolt cover

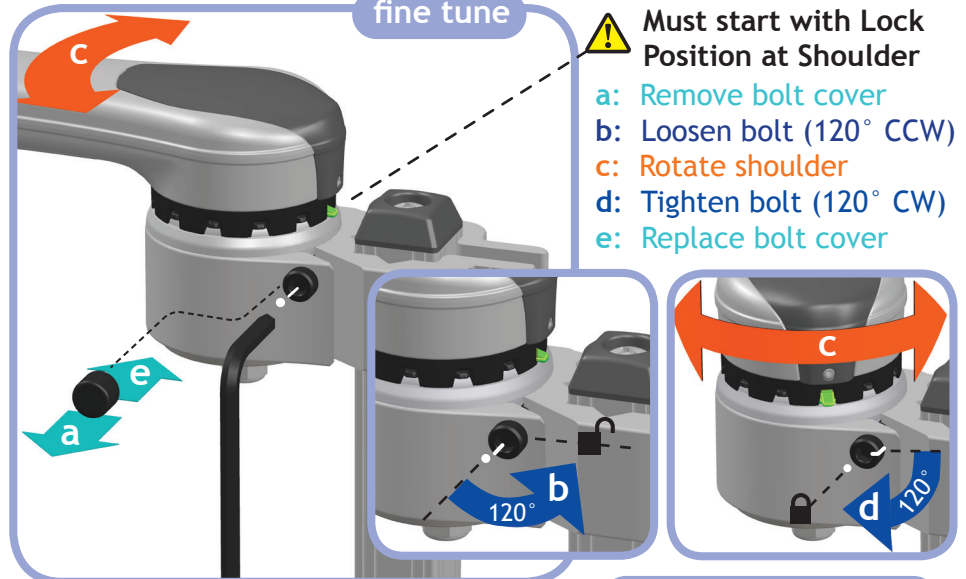

friction adjustment

Locate friction set screw on each joint

Insert a 1/16” hex key

Turn hex key to the right to increase or to the left to decrease joint friction



mount it

- step-by-step instructions and mounting options are available at: www.mountnmover.com

- periodically check that all screws are tight

● 1/4-28 threads

● 1/4-20 threads (T-nut only)

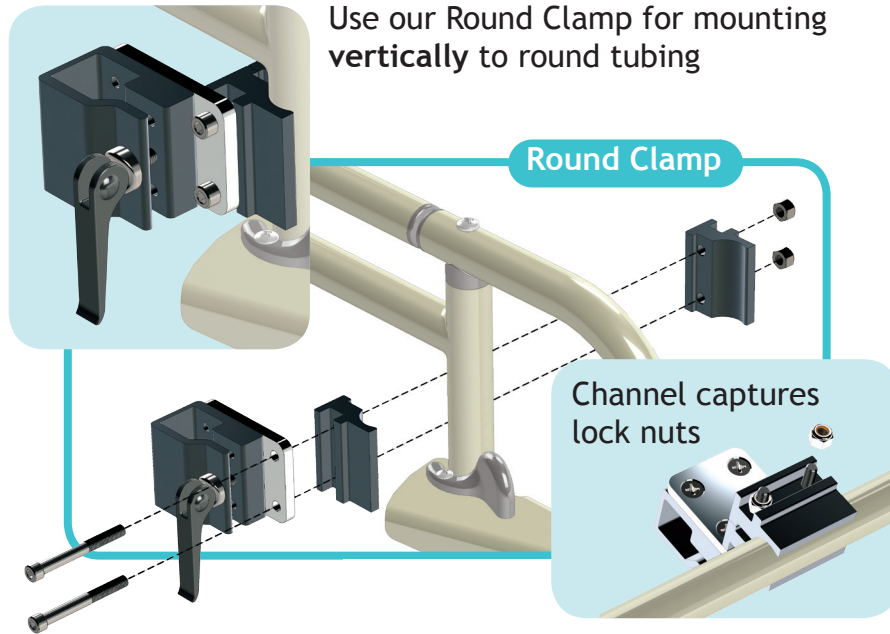

Our Bridge Clamp provides a stable mounting solution for most chairs with round tubing

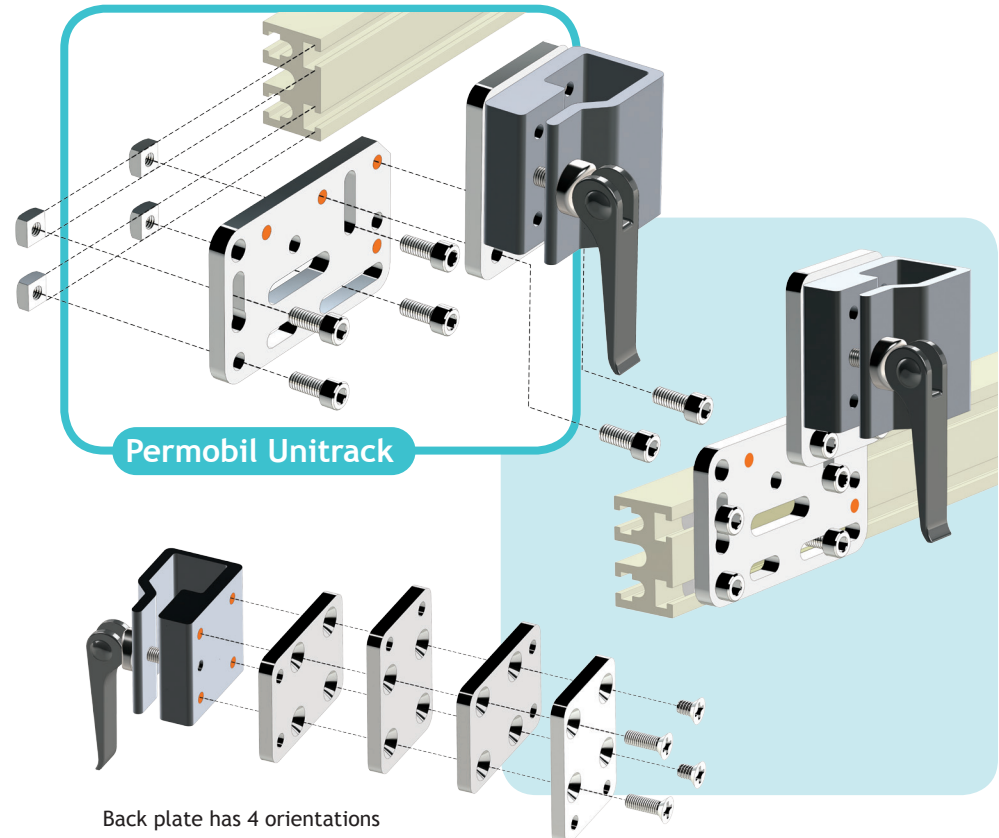
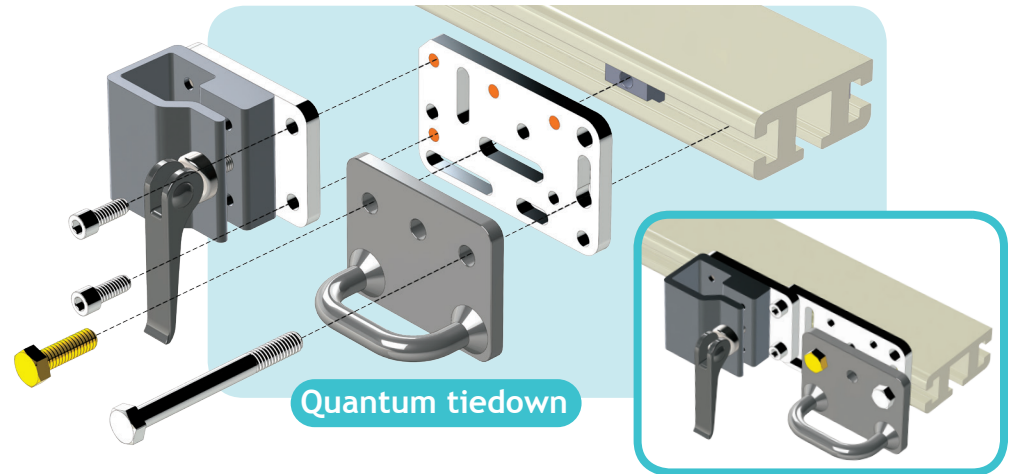
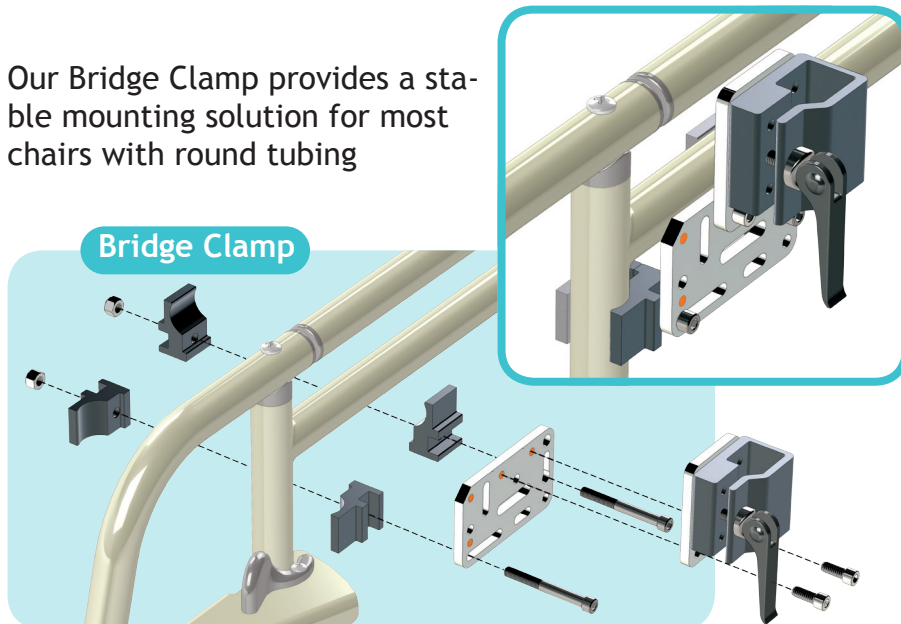

Frame tubing with through holes

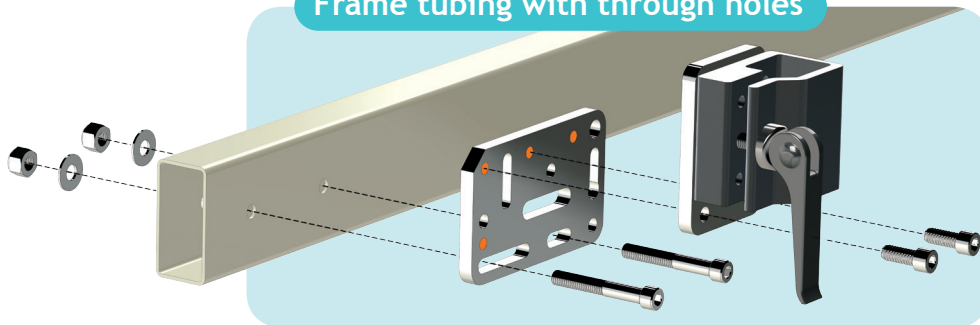

Storm / TDX & Quantum track

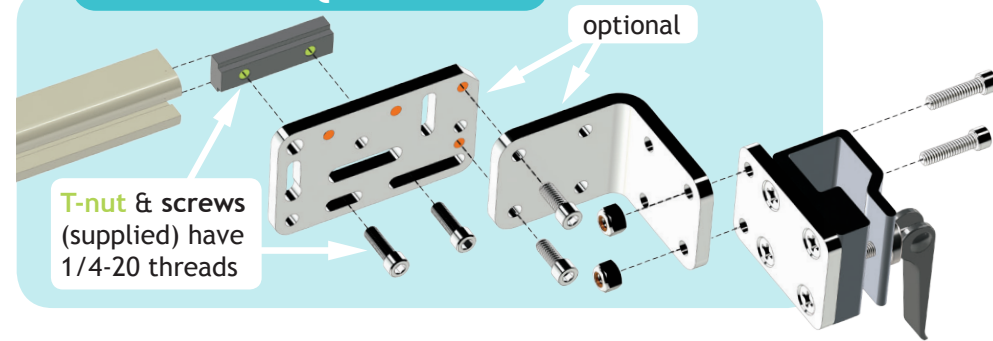

adjust it

- a, b, & c - post should be vertically oriented for the user's typical upright position (dashed line in a)
- d - slots in clamp & post must align
- e - post clamp pressure should be set so that, when clamped, the post is held tightly and securely
- f - post height set screw ensures repeatable height & safety

Angle Adj. Plate

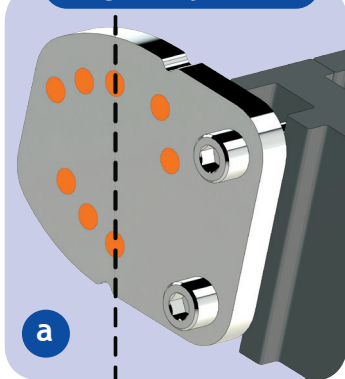

Flip the plate for more angles (every 7.5°)

Solid Wheelchair Bracket

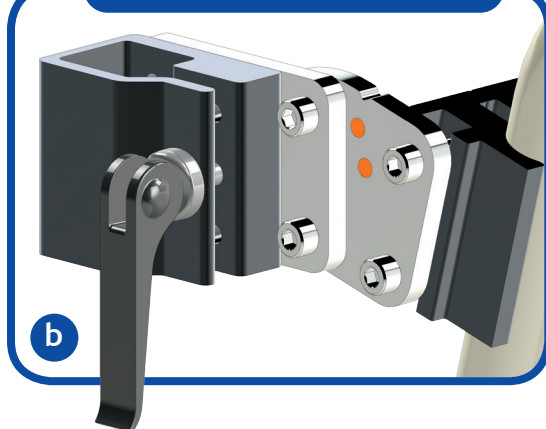

Adjustable Wheelchair Bracket

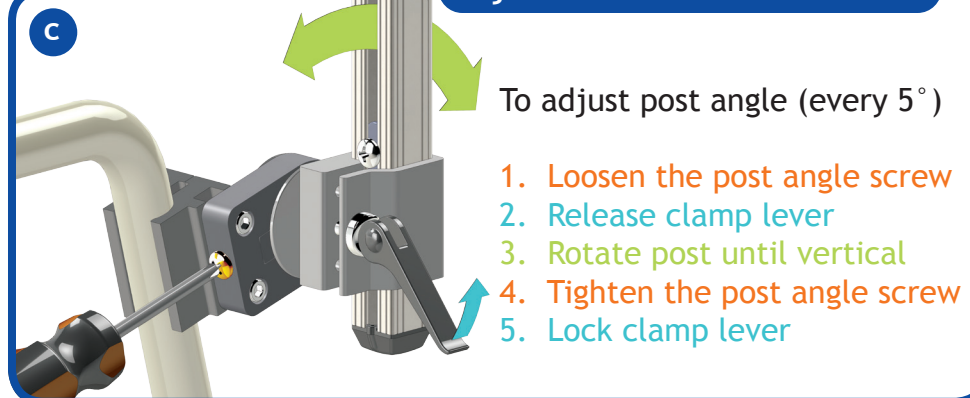

Post alignment

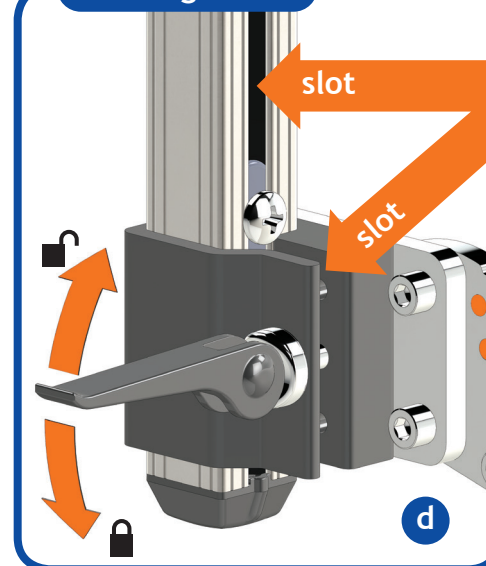

Post is correctly aligned when the post and clamp slots are aligned

Clamp pressure

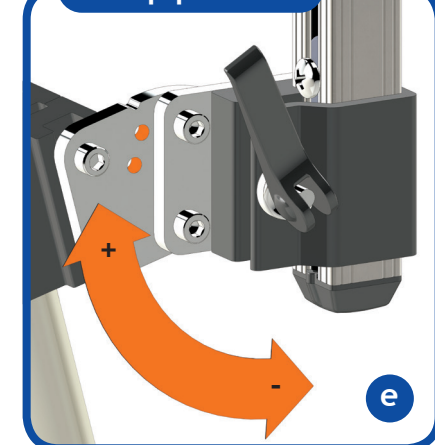

Post height

